

EKO Shut-off Gate Valve PN 10 and PN 16

with soft sealed wedge, ready for mounting of an electric actuator and with mounted electric actuator, flanged, from nodular cast iron

JIHOMORAVSKÁ ARMATURKA spol. s r.o. **JMA**

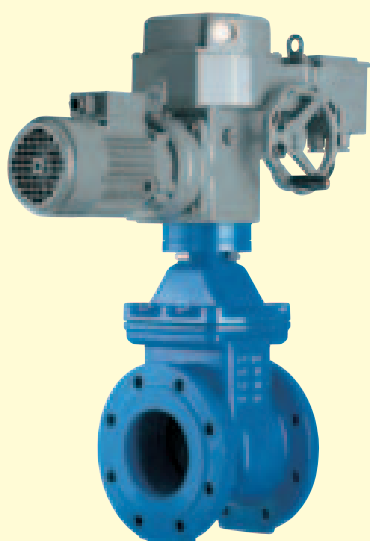

Gate Valve from nodular cast iron EN-GJS-400, rotating non-rising stem with its thread inside the valve chamber. Face-to-Face: Series 14 EN 558-1 (previously F4), Series 15 EN 558-1 (previously F5) or ČSN (previously ČSN 13 3045-2).

OFFER

EKO	PN	Face-to-Face	Operation	Nominal Size DN											
				40	50	65	80	100	125	150	200	250	300	350	400
Type 014	PN 10	Series 14 EN 558-1	ready for el. actuator								■	■	■	■	■
Type 020		ČSN	ready for el. actuator	■	■	■	■	■		■	■	■	■		
Type 018		Series 15 EN 558-1	ready for el. actuator									■	■	■	■
Type 024	PN 10	Series 14 EN 558-1	with el. actuator								■	■	■	■	■
Type 030		ČSN	with el. actuator	■	■	■	■	■		■	■	■	■		
Type 028		Series 15 EN 558-1	with el. actuator									■	■	■	■
Type 013	PN 16	Series 14 EN 558-1	ready for el. actuator	■	■	■	■	■	■	■	■	■	■	■	■
Type 017		Series 15 EN 558-1	ready for el. actuator	■	■	■	■	■	■	■	■	■	■	■	■
Type 023	PN 16	Series 14 EN 558-1	with el. actuator	■	■	■	■	■	■	■	■	■	■	■	■
Type 027		Series 15 EN 558-1	with el. actuator	■	■	■	■	■	■	■	■	■	■	■	■

Order example: EKO type 030 DN 80

DESCRIPTION

Determination

For permanent contact with potable and raw water at permissible service temperature up to 50 °C.

Permissible service overpressure:

Type 014, 018, 020, 024, 028 and 030 max. 1,0 MPa,
Type 013, 017, 023 and 027 max. 1,6 MPa

Application

Shut-off valve for two-way flow direction. Flow velocity max. 3 m/s is allowed at service overpressure up to 1,0 MPa and max. 4 m/s at service overpressure from 1,0 MPa up to 1,6 MPa.

Connecting Dimensions

According to EN 1092-2, flanges Type 21, Form B. Dimensions are given in the table overleaf.

Material of Main Parts

Body, bonnet and wedge from nodular cast iron, wedge covered with EPDM rubber, stem from stainless steel 13% Cr, gland packing from EPDM rubber, stem and packing nut from brass, bonnet screws from stainless steel.

Corrosion Protection

Heavy surface protection of the GSK quality. Parts from cast

iron are coated inside and outside with layer of blue epoxy resin. Corrosion protection of electric actuator according to manufacturer.

Operation

Types 014, 020, 018, 013 and 017 are equipped with the flange ISO 5210, the driven stem end Type B3 ISO 5210. The wedge is closing, when the driven end is turning in clockwise direction.

Types 024, 030, 028, 023 and 027 are supplied with the mounted and adjusted electric actuator MON of basic execution, position transmitter 2x100 Ohm and local position indicator.

Installation and Maintenance

If the service liquid contains a bigger quantity of sedimenting impurities, EKO Gate Valve is to be installed with the stem uppermost.

Details are stated in KAT 10 60-B Part 1, KAT 99 02-B and KAT 99 03-B.

Testing

Tested with water as per DIN 3230 Part 4.

Modifications are possible upon agreement.

DIMENSIONS (mm)

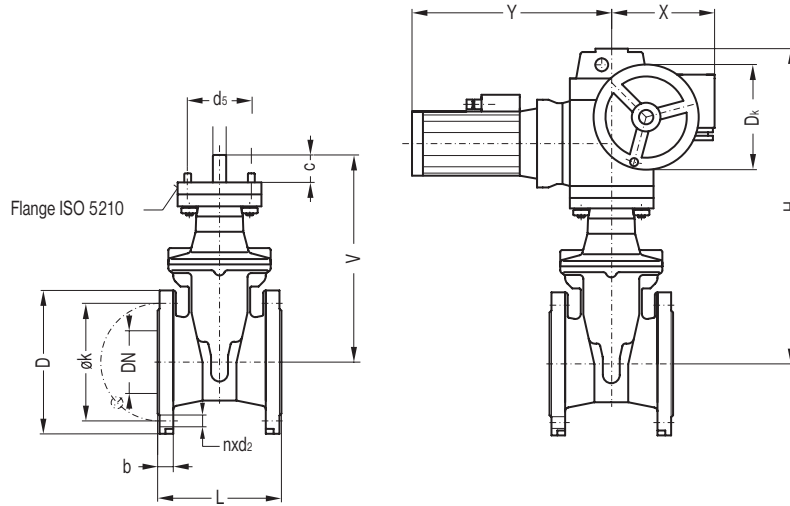

Nominal Size	DN	40	50	65	80	100	125	150	200	250	300	350	400
Face-to-Face L	Series 14	140	150	170	180	190	200	210	230	250	270	290	310
	ČSN	170	180	200	210	230	-	280	330	450	500		
	Series 15	240	250	270	280	300	325	350	400	450	500	550	600
Dimensions	c	45	45	45	45	45	45	45	65	65	65	65	65
	Dk	160	160	160	160	160	160	160	220	220	220	220	304
	d ₁	20	20	20	20	20	20	20	30	30	30	30	30
	d ₅	102	102	102	102	102	102	102	140	140	140	140	140
	H	504	499	537	545	580	629	667	785	883	992	1162	1295
	V	242	237	275	283	318	367	405	530	632	741	911	985
	X	228	228	228	228	228	228	228	230	230	230	230	250
Y	325	325	325	325	325	325	325	417	417	417	417	627	
Flange Dimensions PN 10	b	Corresponds to PN 16. Use Gate Valve PN 16.							20	22	24,5	24,5	24,5
	D								340	395	445	505	565
	d ₂								23	23	23	23	28
	k								295	350	400	460	515
	Holes, off n								8	12	12	16	16
Screw, size								M20	M20	M20	M20	M24	
Flange Dimensions PN 16	b	19	19	19	19	19	19	19	20	22	24,5	26,5	28
	D	150	165	185	200	220	250	285	340	405	460	520	580
	d ₂	19	19	19	19	19	19	23	23	28	28	28	31
	k	110	125	145	160	180	210	240	295	355	410	470	525
	Holes, off n	4	4	4	8 ¹⁾	8	8	8	12	12	12	16	16
Screw, size	M16	M16	M16	M16	M16	M16	M20	M20	M24	M24	M24	M27	
Closing Time (s)		24	30	42	48	48	60	72	51	101	120	142	76
Loss Factor ²⁾		0,20	0,17	0,15	0,13	0,12	0,12	0,11	0,10	0,09	0,07	0,06	0,04
Weight (kg)	Type 013	10,0	12,0	15,5	17,5	27,5	37,5	49,5	86,7	124	161	257	320
	Type 017	11,6	13,0	17,5	19,0	29,0	40,0	51,0	95,7	129	185	286	358
	Type 020	10,5	12,5	16,0	18,0	28,0		50,0	89,0	129	185		
	Type 023	46,0	47,0	50,5	52,5	63,5	73,0	85,5	142	180	217	313	433
	Type 027	46,6	48,0	52,5	54,0	65,0	76,0	87,0	151	185	241	342	471
	Type 030	45,5	47,5	51,0	53,0	64,0		86,0	144	185	241		

¹⁾ 4 holes for PN 10 upon request only.

²⁾ Measured in the fully open position.

Dimensions of electric actuator and its weight can be different according to used type

